

Solway precast

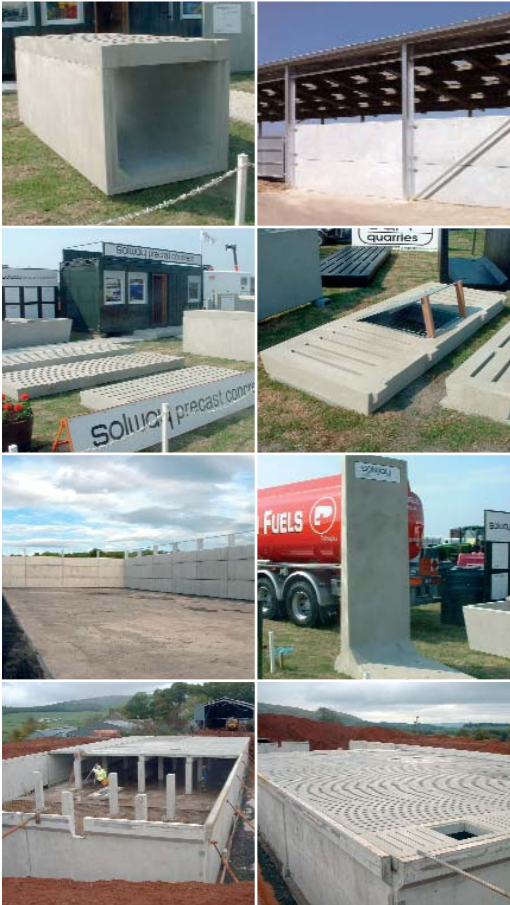

Agricultural Precast
Direct from Factory to Farm

SOLWAY

precast

SOLWAY PRECAST are now regarded as the UK's leading manufacturer of agricultural precast delivering direct from our manufacturing facility at Barrhill in Ayrshire to the customers farm. All agricultural precast products are stocked in standard sizes or can be manufactured to the customers requirements.

Solway Precast over the past 60 years have built up a reputation amongst the UK farming industry of quality and meticulously designed products which are functional, efficient, durable and attractive to the eye.

Contents

| | |
|------------------------------------|----|
| Cattle Slats | 3 |
| Modular Slurry System | 4 |
| Slurry Handling Channel | 5 |
| Free Standing Retaining Wall Units | 6 |
| Effluent Tanks | 7 |
| Water and Feed Troughs | 8 |
| Slatted Hatch Panels | 9 |
| Silage & Stock Wall Panels | 10 |
| Installation and Construction | 11 |
| Contact Us | 12 |

Cattle Slats

| TYPE | LENGTH | WIDTH | DEPTH | LOADING |
|--------|----------------------------|------------------------|----------------|---|
| Single | Up to 3.66m (12ft) | 0.15m/0.23m (6"/9") | 0.178m (7") | Cattle, 4T Tractor |
| Double | Up to 3.66m (12ft) | 0.33m (1ft) | 0.2m (8") | Cattle, 4T Tractor |
| Treble | Up to 3.66m (12ft) | 0.5m (1ft 8") | 0.2m (8") | Cattle, 4T & 6T Tractor |
| Panel | 1.8m to 3m (6-10ft) | 1m (3ft 3") | 0.178m (7") | Cattle, 4T & 6T Tractor |
| Maxi | Up to 3.66m (12ft) | 1.2m (4ft) | 0.178m (7") | Cattle, 4T Tractor |
| Big T | 3m to 4m (10ft to 13ft) | 1.2m (4ft) | 0.2m (8") | Cattle, 4T & 6T Tractor & Road Loading (10T) |
| Mega | Up to 5m (16ft 5") | 1.2m (4ft) | 0.25m (10") | Cattle, 4T & 6T Tractor |

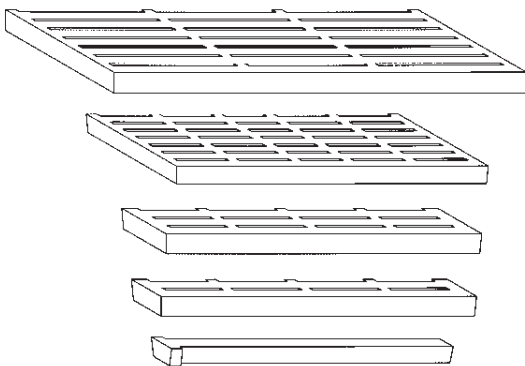

- Compatible with Solway Precast Slurry Handling Channel and Transfer Channel
- Non Standard Units available

Modular Slurry System

MAXIMUM DEPTH

2.5m (8ft 4")

LENGTH

Standard Panels 6.096m (20ft) & 4.572m (15ft)
Multiple panels to create any length required

BREADTH

Single breadth to suit Solway Precast cattle slats up to 4m. Multiple breadth to suit any combination of Solway Precast cattle slats and passage slabs to create any breadth required.

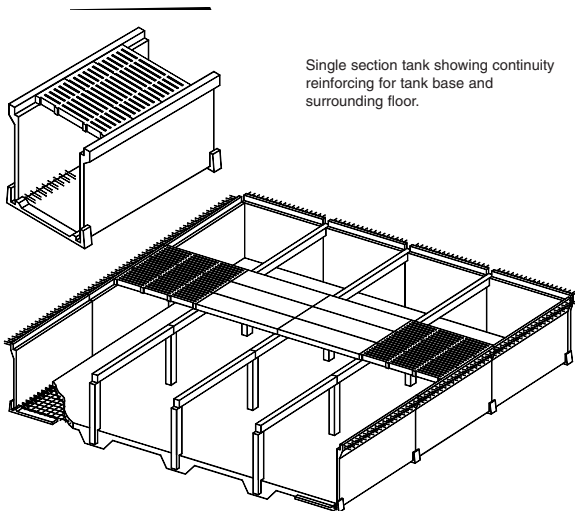

Single section tank showing continuity reinforcing for tank base and surrounding floor.

Stability of the precast columns and floor beams relies on the precast floor slab/slat panels for stability. The stability of each individual tank should be assessed by a Chartered Engineer

- Revolutionary design 'no more shuttering'
- To fit standard Solway Precast Panel Slats
- All joints sealed
- For slurry handling and storage
- Patent applied for

Slurry Handling Channel

MAXIMUM INSIDE DEPTH 2.5m (8ft 4")

LENGTH 2m (6ft 7")

OVERALL BREADTH 2.4m (7ft 10"), 3.0m (9ft 10")
up to 4m (13ft 1") with insitu infill

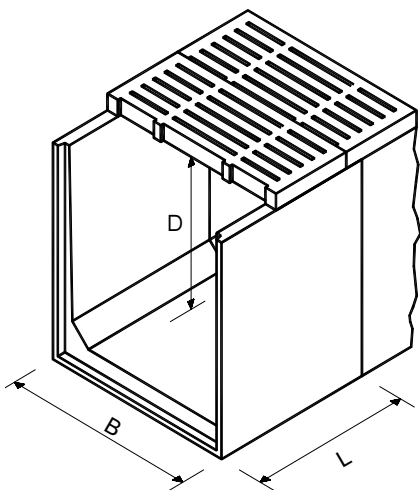

- To fit standard Solway Precast panel slats
- Approved for grant by the Agricultural and Fisheries Department of SEPA
- All joints sealed
- For slurry handling or storage

Free Standing Retaining Wall Units (Grain/Silage/Earth)

| HEIGHT | WIDTH | DEPTH |
|-------------------|---------------|---------------|
| Up to 3.0m (10ft) | 1.0m (3ft 3") | 1.7m (5ft 7") |

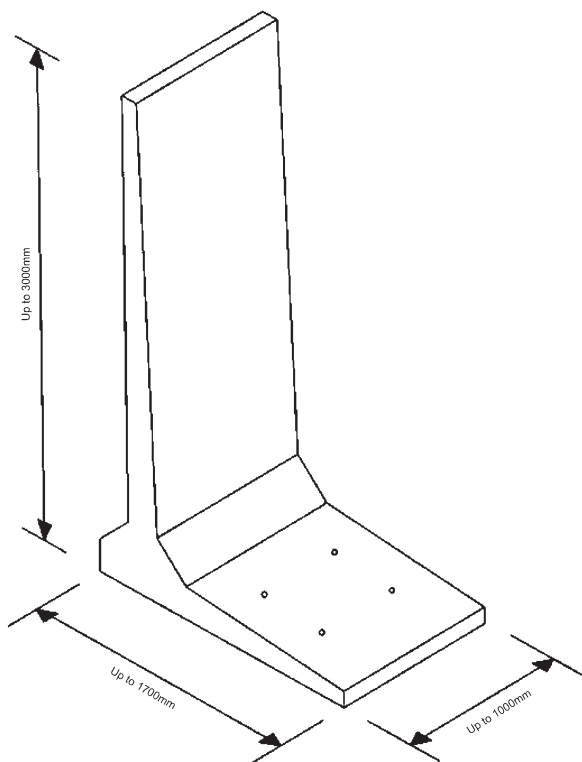

- For storage of silage, grain and fertiliser
- Units are portable to suit

Effluent Tanks

| LENGTH | WIDTH | HEIGHT |
|----------------|-----------------|------------|
| 3.2m (10ft 6") | 2.42m (7ft 11") | 0.6m (2ft) |

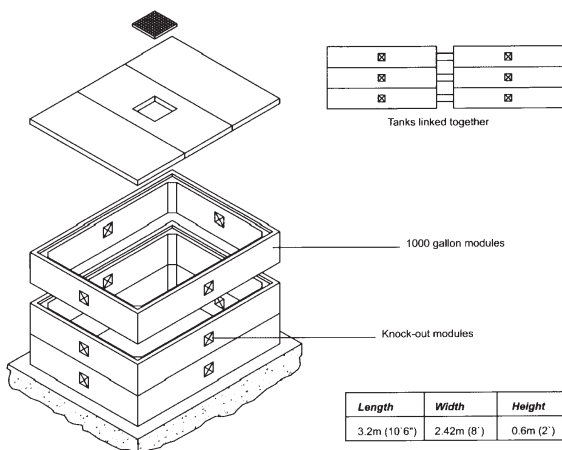

- Maximum 5000 gallon capacity in single installation
- Tanks can be linked to increase capacity
- Sectional tanks in 1000 gallon modules below or above ground
- Approved for grant application SEPA & DEFRA

Water & Feed Troughs

Water Trough

(2000 Litres/450 Gallons nominal)

| LENGTH | WIDTH | HEIGHT |
|----------------|-------------|----------------|
| 2.85m (9ft 4") | 1.52m (5ft) | 0.75m (2ft 6") |

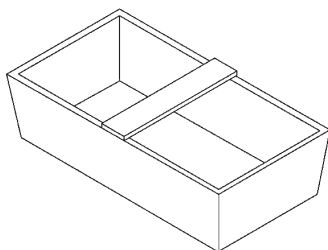

Precast Feed Trough

| TYPE | LENGTH | WIDTH | HEIGHT |
|-------|---------------|---------------|----------------|
| Small | 2.0m (6ft 7") | 1.52m (5ft) | 0.75m (2ft 6") |
| Large | 3.0m (10ft) | 1.0m (3ft 3") | 1.0m (3ft 3") |

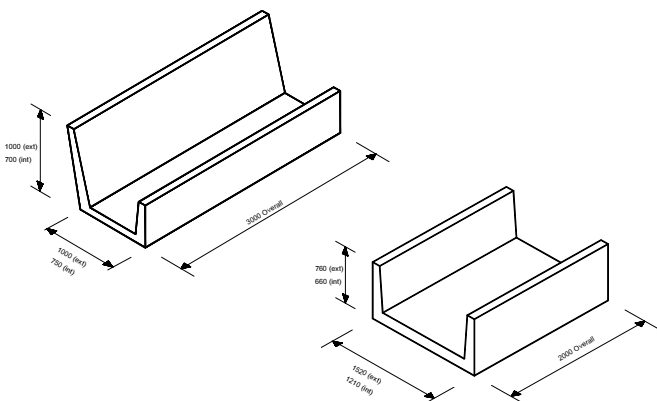

- Specials made to order

Slatted Hatch Panel

| LENGTH | WIDTH | DEPTH | LOADING |
|-----------------|------------|-----------|--|
| Up to 4m (14ft) | 1.2m (4ft) | 0.2m (8") | Cattle, 4T & 6T Tractor, Road Loading |

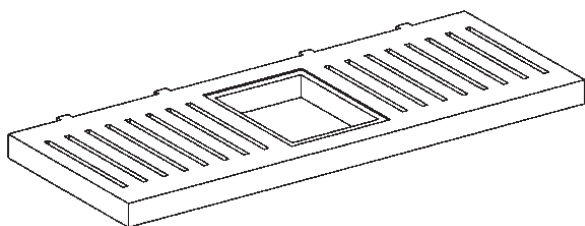

- Compatible with Solway Precast slurry handling channel
- Non standard units available

Grain/Silage & Stock Wall Panels

| LENGTH | THICKNESS | INDIVIDUAL UNIT HEIGHT |
|-------------------|--------------------------------------|--|
| Up to 6.0m (20ft) | 0.1m (4"), 0.135m (5") 0.150 (6") | 1.0m (3ft 3"), 1.2m (4ft), 1.5m (5ft) |

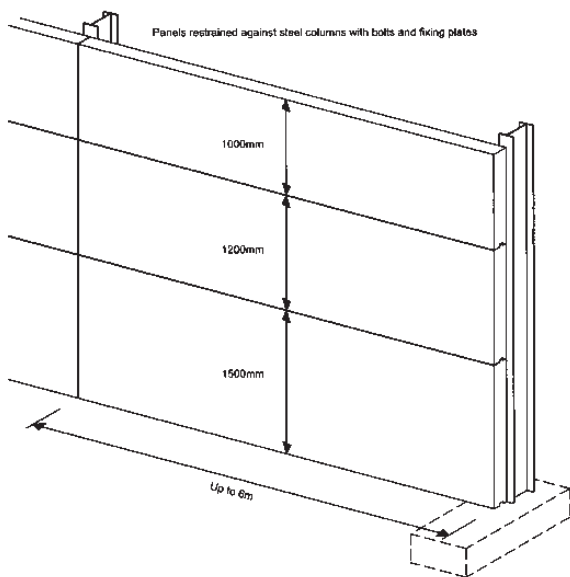

Also

- 200mm thick panels available for up to 6m (20ft) high walls
- Double seals in all gaps between panels
- Specials made to order

Installation and Construction

Horizontal Panels

Using lifting shackles and straps, the panels are lifted from their stack by the sockets cast near the upper side. The units are placed and centred against the columns then secured using the steel fixing clips, bolts and cast-in sockets (fig 4). Alternatively, the panels may be fixed within the columns against either flange and held in place with a retaining angle (fig 5).

The panels may be allowed to rest on the floor slab as no special foundation is required, or can be seated on suitable landing cleats, as in figure 6. A soft packing should be used between cleat and panel where the bay length exceeds 4.5m or the height 3m.

Adjoining panels are erected similarly, leaving a 10-20mm gap between units at the centre of the column. Panels are lowered, male joint uppermost onto the panel below. Prestressed panels generally exhibit a camber, which will vary with length, strand pattern and other factors. Variations can also occur due to positioning of the stacking timers.

Note: All panels should be handled individually. At no time should they be lifted in multiples, even two at a time.

Typical Corner Details

Care may be needed to ensure that panels of similar camber are matched during installation.

Corner details are typically as in figures 7 & 8.

The panels are sealed after they have been installed. Where a watertight seal between the bottom panel and floor is required, the panel can, in some circumstances, be concreted into the floor with a top seal between the outside of the panel and the concrete ensuring a waterproof joint. Alternatively, a kerb can be cast to the back of the panel (fig 9), having a compressible packing topped with sealant between the two allowing the panels to deflect under load.

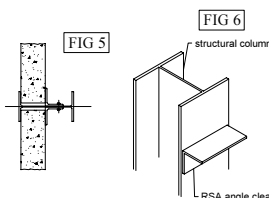
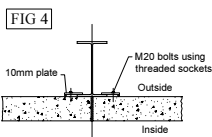

N.B. Cleat must be appropriate for panel width

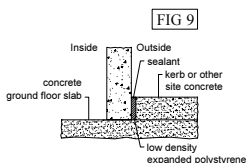
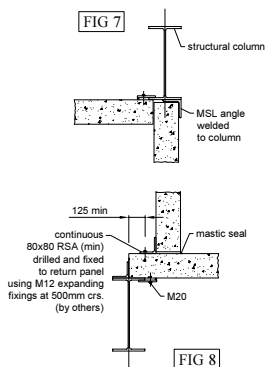

Solway

precast

Braehead

Barrhill

Girvan

Ayrshire

KA26 0QR

Tel: 01465 821348

Fax: 01465 821383

Email: sales@solway-precast.co.uk

Website: www.solwayprecast.co.uk



***UK's leading Agricultural Precast
Manufacturer direct from factory to farm***



FM 40916